

PROJECT MANAGER MANGIARACINA, DEBORAH, P.E. (757)375-4870, CITY OF NORFOLK  
SURVEYED BY, DATE PRECISION MEASUREMENTS, INC. (757) 368-945, MAY 2022  
DESIGN BY ANGELA CALLAN, P.E. (757)213-8600, KIMLEY-HORN & ASSOCIATES, INC.  
SUBSURFACE UTILITY BY, DATE MISS UTILITY, MAY 2022

THE COMPLETE ELECTRONIC .PDF VERSION OF THE PLAN ASSEMBLY AS  
AWARDED, INCLUDING ALL SUBSEQUENT REVISIONS, WILL BE THE OFFICIAL  
CONSTRUCTION PLANS. FOR INFORMATION  
RELATIVE TO ELECTRONIC FILES AND LAYERED PLANS, SEE GENERAL NOTES.

DESIGN FEATURES RELATING TO CONSTRUCTION OR TO REGULATION AND  
CONTROL OF TRAFFIC MAY BE SUBJECT TO CHANGE AS DEEMED NECESSARY BY  
THE DEPARTMENT.

THIS PROJECT IS TO BE CONSTRUCTED IN ACCORDANCE WITH THE  
DEPARTMENT'S 2020 ROAD AND BRIDGE SPECIFICATIONS, 2016 ROAD AND  
BRIDGE STANDARDS, 2009 MANUAL ON UNIFORM TRAFFIC CONTROL DEVICES  
(MUTCD, REV 1 AND 2 INCORPORATED MAY 2012), 2011 VIRGINIA SUPPLEMENT  
TO THE MUTCD, 2011 VIRGINIA WORK AREA PROTECTION MANUAL (REV 2.1  
INCORPORATED NOVEMBER 1, 2020), AND AS AMENDED BY CONTRACT  
PROVISIONS AND THE COMPLETE ELECTRONIC PDF VERSION OF THE PLAN  
ASSEMBLY.

THE ORIGINAL APPROVED TITLE SHEET(S), INCLUDING ORIGINAL SIGNATURES, IS  
FILED IN THE VDOT CENTRAL OFFICE PLAN LIBRARY. ANY MISUSE OF  
ELECTRONIC FILES, INCLUDING SCANNED SIGNATURES, IS ILLEGAL AND  
ENFORCED TO THE FULL EXTENT OF THE LAW.

NOTES:

1. RECORD DRAWING AND CONSTRUCTION  
CERTIFICATION NOTE: THE STORMWATER  
MANAGEMENT/BMP FACILITY AND  
ASSOCIATED STORMWATER CONVEYANCE  
SYSTEM(S) AS PROPOSED FOR THIS  
PROJECT WILL REQUIRE THE SUBMISSION,  
REVIEW AND APPROVAL OF A RECORD  
DRAWING (AS-BUILT) AND CONSTRUCTION  
CERTIFICATION PRIOR TO FINAL  
ACCEPTANCE. RECORD DRAWING AND  
CONSTRUCTION CERTIFICATION IS  
REQUIRED TO BE RECORDED AND  
CHECKED BY A LICENSED SURVEYOR.
2. STORMWATER NOTE: CONTRACTOR TO  
CONTACT ENVIRONMENTAL STORMWATER  
MANAGEMENT AT 823-4089 (48-HOUR  
NOTICE) FOR PRE-CONSTRUCTION  
CONFERENCE AND INSPECTION  
REQUIREMENT WHEN A BMP IS PROPOSED  
AND/OR TIE-IN TO CITY STORM DRAIN  
SYSTEM.
3. TOLERANCE NOTES:  
3.A. ALL STORM DRAINAGE SHALL BE  
INSTALLED WITHIN 0.10' (ONE TENTH  
OF A FOOT) OF THE ELEVATION  
SHOWN ON THE PLAN, OR AS  
SPECIFIED IN WRITING BY THE CITY.  
3.B. MINIMUM STORM SEWER SLOPE  
SPECIFIED ON THE PLAN ARE  
ABSOLUTE MINIMUM. LESSER SLOPE  
WILL NOT BE ACCEPTED UNLESS IN  
WRITING BY THE CITY.  
3.C. CONTRACTOR TO BE RESPONSIBLE  
FOR ALL CORRECTION COST (I.E.  
PLAN REVISION, PHYSICAL  
CORRECTION, ETC.) REQUIRED AS A  
RESULT OF INSTALLATION NOT  
MEETING THE TOLERANCE  
REQUIREMENT.
4. THE CONTRACTOR SHALL CONTACT THE  
CITY OF NORFOLK, BUREAU OF  
ENVIRONMENTAL SERVICES AT  
757-664-4368 AT LEAST 48 HOURS  
PRIOR TO ANY LAND DISTURBING  
ACTIVITY SO THAT A LAND DISTURBING  
PERMIT CAN BE ISSUED, AND PRE  
CONSTRUCTION CONFERENCE CAN BE  
SCHEDULED.
5. THIS SITE REQUIRES A VSMP  
CONSTRUCTION GENERAL PERMIT FOR  
STORMWATER DISCHARGES FROM  
CONSTRUCTION ACTIVITIES. THE  
CONTRACTOR IS REQUIRED TO SECURE  
PERMIT COVERAGE FROM THE VIRGINIA  
DEPARTMENT OF ENVIRONMENTAL  
QUALITY (DEQ) PRIOR TO COMMENCEMENT  
OF ANY LAND DISTURBANCE REQUIRED  
BY THE PROJECT BY SUBMITTING A  
COMPLETE REGISTRATION STATEMENT AND  
PAYING THE APPROPRIATE PERMIT FEE  
TO THE CITY OF NORFOLK. THE  
CONTRACTOR IS RESPONSIBLE FOR  
ENSURING PERMIT COMPLIANCE CURING  
CONSTRUCTION INCLUDING BUT NOT  
LIMITED TO INSPECTIONS, SWPPP  
UPDATES, ETC. CONTACT NORFOLK  
ENVIRONMENTAL SERVICES AT  
757-644-4368 FOR FURTHER  
INFORMATION. THIS PROJECT UTILIZES  
PART IIB CRITERIA FOR DETERMINING IT'S  
POST DEVELOPMENT STORM WATER  
MANAGEMENT DESIGN.

THE CONTRACTOR SHALL CONTACT THE CITY OF NORFOLK, BUREAU OF  
ENVIRONMENTAL SERVICES AT 664-4368 AT LEAST 48 HOURS PRIOR TO  
ANY LAND DISTURBING ACTIVITY SO THAT A LAND DISTURBING PERMIT CAN  
BE ISSUED, AND A PRECONSTRUCTION CONFERENCE CAN BE SCHEDULED.

TOTAL LAND DISTURBANCE AREA: 1.54 ACRES  
PRE DEVELOPMENT IMPERVIOUS AREA: 0.03 (ACRES)  
POST DEVELOPMENT IMPERVIOUS AREA: 0.59 (ACRES)



COMMONWEALTH OF VIRGINIA

PLAN OF PROPOSED  
CITYWIDE PEDESTRIAN  
SAFETY IMPROVEMENTS  
SP2023-0003

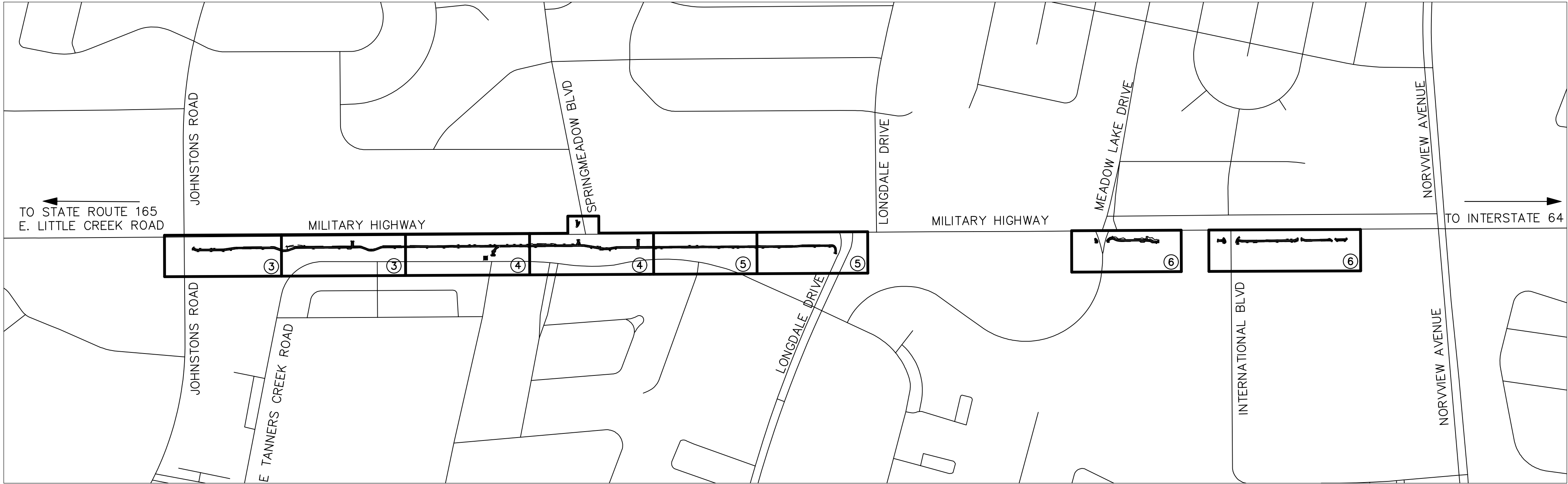

SEE SHEET 7 FOR INTERSECTION OVERVIEW AND MAP.

VICINITY MAP  
1" = 350'

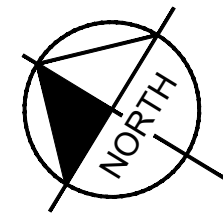

CITY OF NORFOLK POPULATION 238,005 (2020 CENSUS)

STATE PROJECT NO.	SECTION	FEDERAL AID PROJECT NO.	TYPE CODE	UPC NO.	LENGTH INCLUDING BRIDGE(S)		LENGTH EXCLUDING BRIDGE(S)		TYPE PROJECT	DESCRIPTION
					FEET	MILES	FEET	MILES		
U000-122-407	PE-101	STP-5A03(957)		112759	4,169	0.789	4,169	0.789	PRELIM. ENG.	FR: JOHNSTONS RD TO: NORVIEW AVE
	RW-201	STP-5A03(072)		112759	4,169	0.789	4,169	0.789	RIGHT-OF-WAY	FR: JOHNSTONS RD TO: NORVIEW AVE
	C-501	STP-5A03(073)	1000	112759	4,169	0.789	4,169	0.789	CONSTRUCTION	FR: JOHNSTONS RD TO: NORVIEW AVE

NOTE: PROJECT LENGTH BASED ON CONSTRUCTION BASELINE

FHWA-534-43128  
UPC 112759

STATE	FEDERAL AID		STATE		SHEET NO.
	PROJECT		ROUTE	PROJECT	
VA.	STP-5A03(957)		165	U000-122-407 SEE TABULATIONS BELOW FOR SECTION NUMBERS	1

FUNCTIONAL CLASS. AND TRAFFIC DATA

MILITARY HIGHWAY (VA 165) - OTHER PRINCIPAL ARTERIAL  
UNDIVIDED - FLAT 45 MPH MIN. DESIGN SPEED (GS-5)

	FR: NORVIEW AVE TO: LITTLE CREEK RD
AADT (2020)	19,000
DHV	1600
D (%)	53% (SB PM)
T (%)	3.0%
V (MPH)	45 MPH

PROPOSED BMP SCHEDULE:

OWNER: CITY OF NORFOLK  
TYPE OF FACILITY: HYDRODYNAMIC SEPARATOR (HDS)  
WATER QUALITY/ QUANTITY STORAGE REQUIRED: 12,493 (CF)  
AREA TREATED: 5.73 (AC)  
NORTHING: 3497091.60  
EASTING: 12146035.63

TIER 1 PROJECT

LOCALLY ADMINISTERED PROJECTS CITY OF NORFOLK	
RECOMMENDED FOR APPROVAL FOR RIGHT OF WAY ACQUISITION	
DATE	CITY TRANSPORTATION ENGINEER
DATE	DEPARTMENT OF PLANNING AND COMMUNITY DEVELOPMENT

THIS PROJECT WAS DESIGNED UTILIZING  
AUTOCAD CIVIL 3D 2022 DESIGN  
SOFTWARE. UPC NO. (112759)  
Copyright 2023, Commonwealth of Virginia



Plotted By: Meyer, Morgan Sheet Set: CITYWIDE PEDESTRIAN SAFETY IMPROVEMENTS Layout: 3A DEMOLITION AND E&S PLAN August 14, 2023 09:26:40am K:\VAB-TP10\116057175 - Norfolk Multimodal Improvements\CADD\Plan Sheets\DEMO-116057175.dwg

This document, together with the concepts and designs presented herein, as an instrument of service, is intended only for the specific purpose and client for which it was prepared. Reuse of and improper reliance on this document without written authorization and adaptation by Kimley-Horn and Associates, Inc. shall be without liability to Kimley-Horn and Associates, Inc.

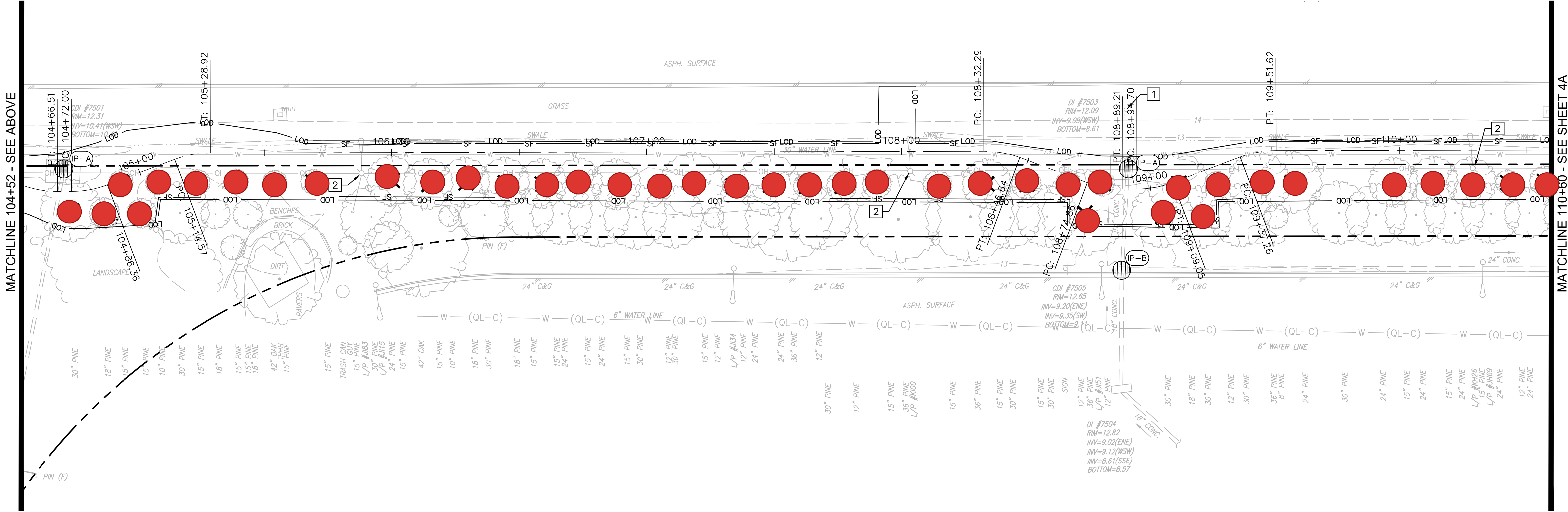
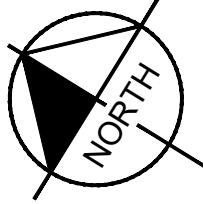
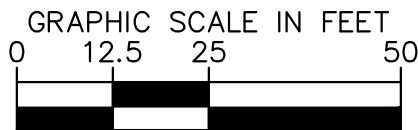

52 trees to be removed

- LEGEND**
- REMOVE EXISTING TREE
  - DEMOLITION OF RIGID PAVEMENT
  - DEMOLITION OF FLEXIBLE PAVEMENT
  - INLET PROTECTION PER VDOT STD EC-6
  - SILT FENCE (TYPE A)
  - LIMITS OF DISTURBANCE

- CONTRACTOR TO SALVAGE EXISTING SIGN PANEL AND DEMOLISH EXISTING SIGN POST AND FOUNDATION
- DO NOT DISTURB EXISTING UTILITY
- ADJUST UTILITY TO GRADE
- SAWCUT EXISTING PAVEMENT
- DEMOLISH EXISTING CURB
- ERADICATE EXISTING PAVEMENT MARKINGS
- CONTRACTOR TO REMOVE EXISTING PUSH BUTTON AND SIGN
- CONTRACTOR TO REMOVE EXISTING SP-9 PEDESTRIAN SIGNAL HEAD AND PUSH BUTTON

**NOTES:**

- CONTRACTOR TO COORDINATE WITH DOMINION ENERGY FOR TREE REMOVAL IN CLOSE PROXIMITY TO OVERHEAD UTILITIES.
- THE CONTRACTOR SHALL APPLY ECS-1B BIODEGRADABLE MATTING OR AND APPROVED OTHER IN ACCORDANCE WITH VDOT STD. EC-3 TO ALL DISTURBED AREA WITHIN THE RIGHT OF WAY FOR FINAL STABILIZATION. THE COST OF THE MATTING SHALL BE INCIDENTAL TO THE SQUARE ACRE COST OF TOPSOIL CLASS A 2"
- THE CITY OF NORFOLK DOES NOT ALLOW GRAVEL/WIRE MESH INLET PROTECTION WITHIN THE CITY RIGHT OF WAY

CITYWIDE PEDESTRIAN SAFETY IMPROVEMENTS  
PREPARED FOR  
CITY OF NORFOLK

DEMOLITION AND E&S PLAN  
JOHNSTONS TO LONGDALE  
STA. 100+00 TO STA. 110+50

KHA PROJECT  
116057175  
DATE  
08/14/2023  
SCALE AS SHOWN  
DESIGNED BY MAM  
DRAWN BY MAM  
CHECKED BY AFC

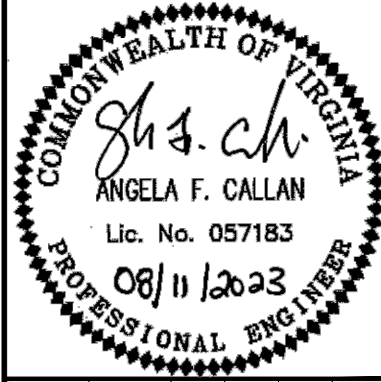

**Kimley»Horn**  
© 2023 KIMLEY-HORN AND ASSOCIATES, INC.  
4525 MAIN STREET, SUITE 1000, VIRGINIA BEACH, VA 23462  
PHONE: 757-213-8600 FAX: 757-213-8601  
WWW.KIMLEY-HORN.COM

No.	REVISIONS	DATE	BY

MATCHLINE 104+52 - SEE BELOW



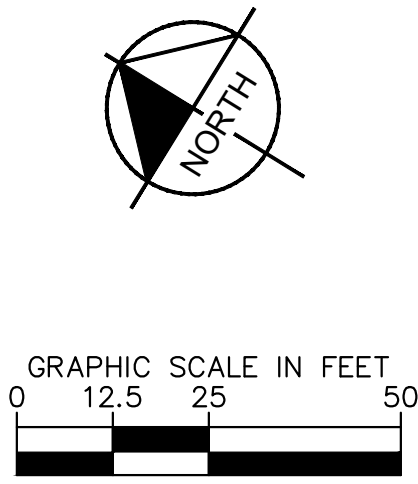

18 trees to be planted

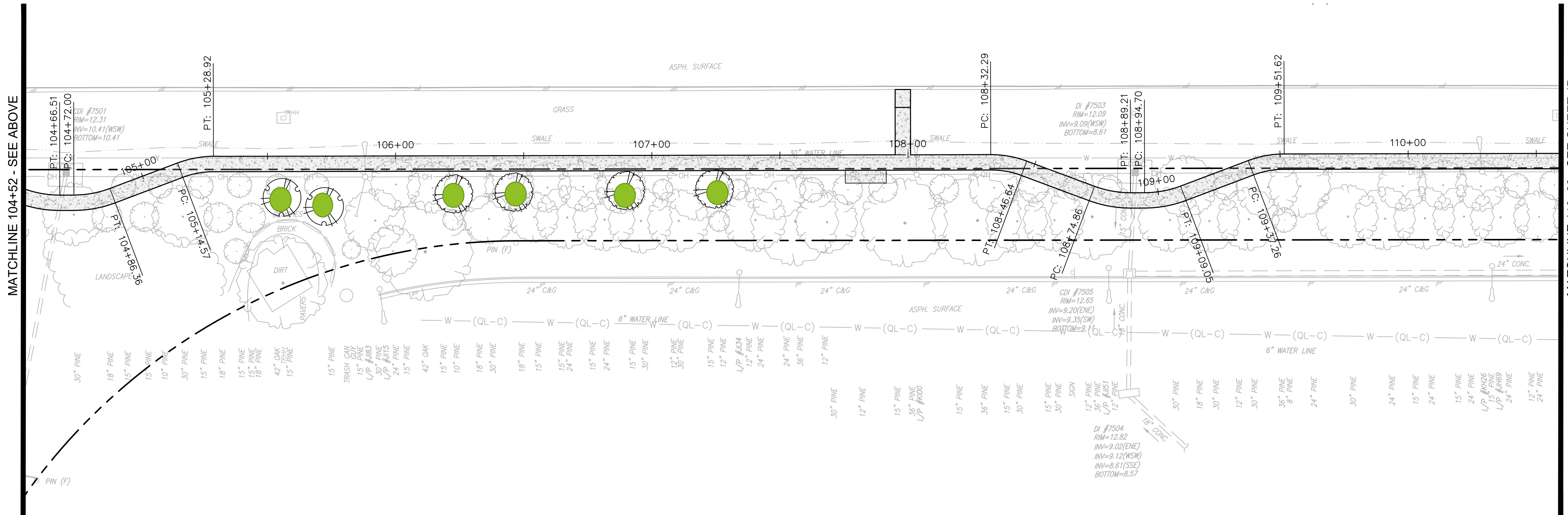





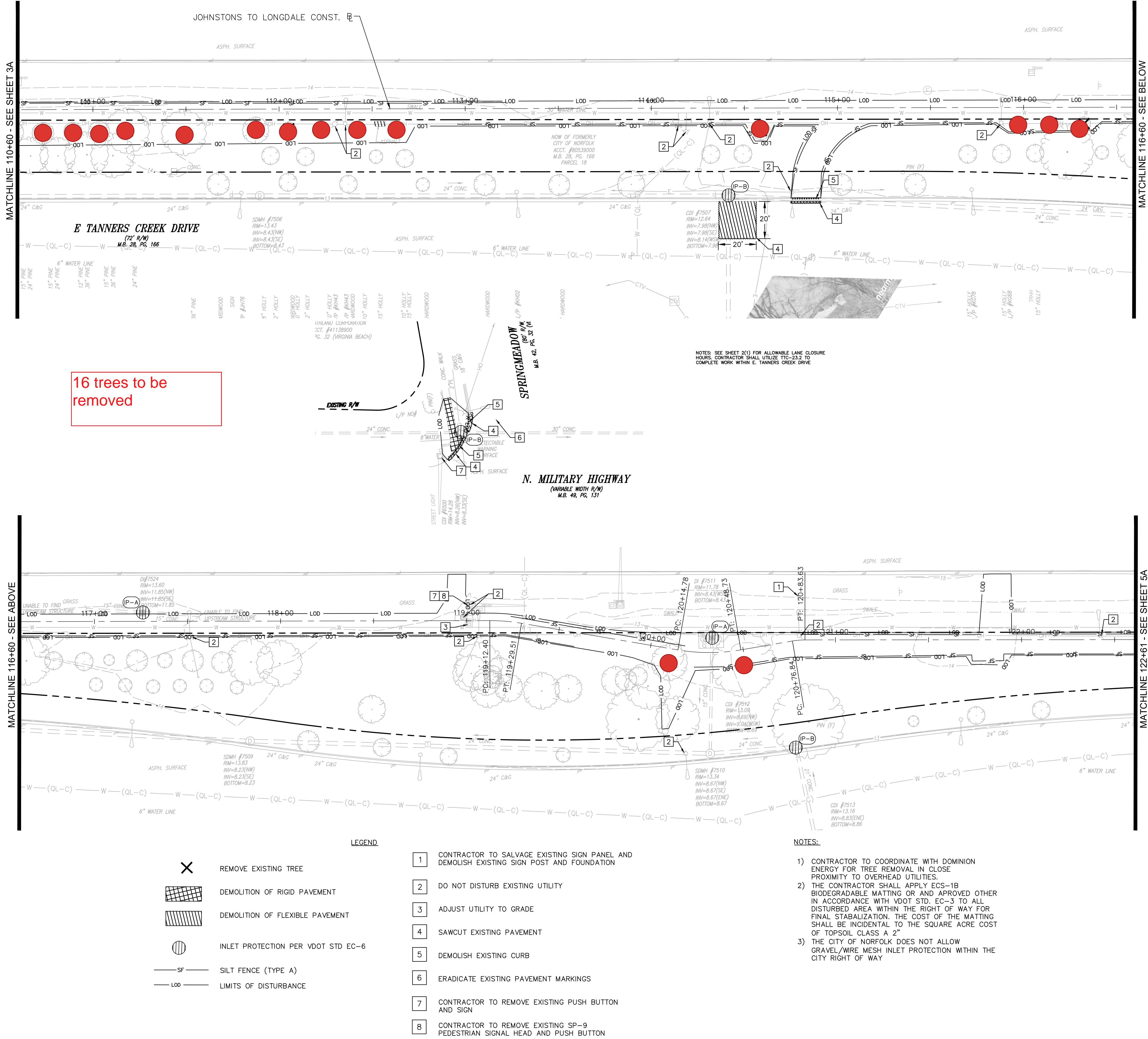
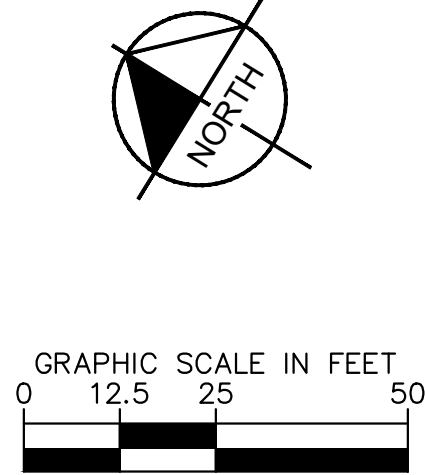



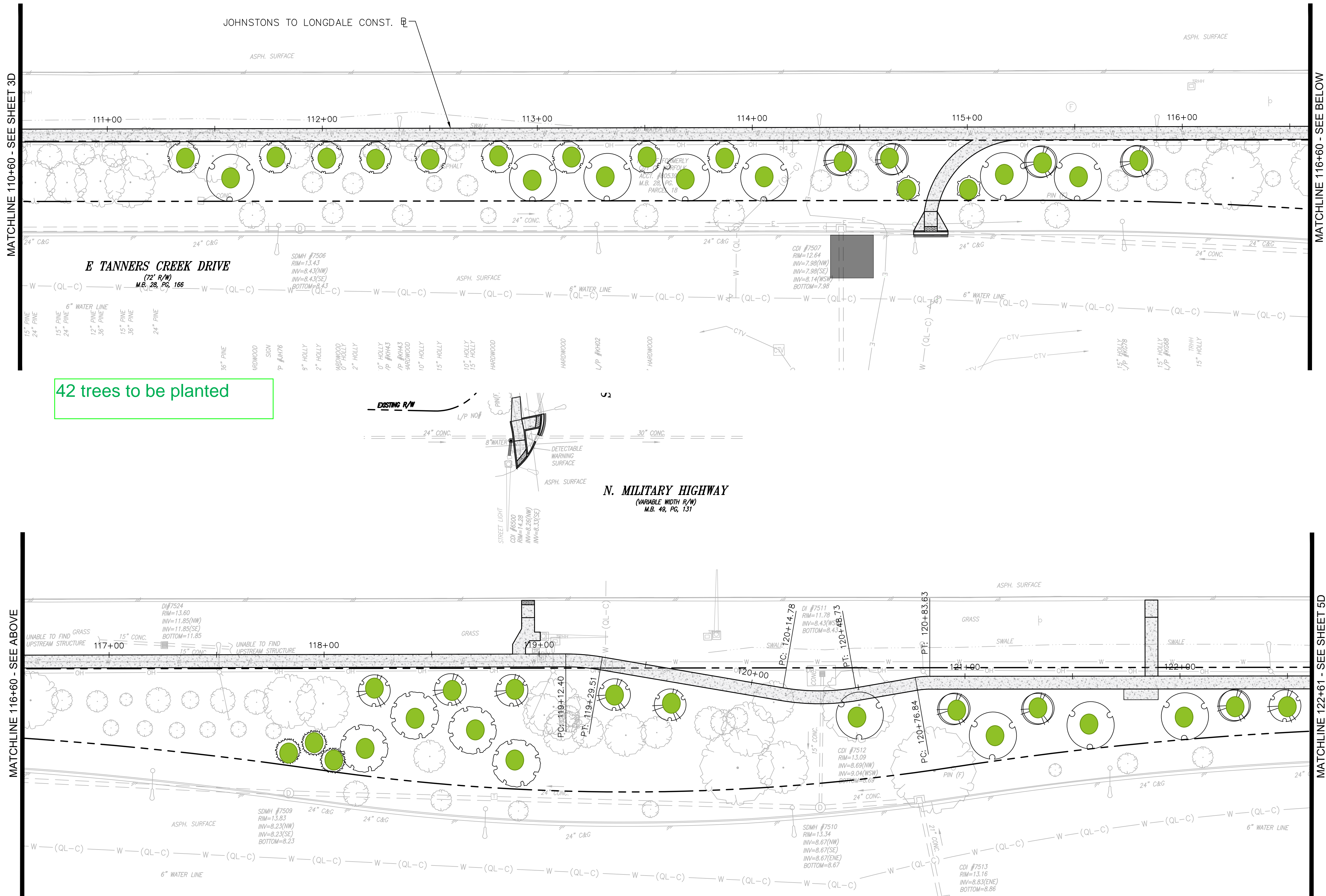

Plotted By: Meyer, Morgan Sheet Set: CITYWIDE PEDESTRIAN SAFETY IMPROVEMENTS Layout: 4A DEMOLITION AND E&S PLAN August 14, 2023 09:28:49am K:\VAB-TP10\116057175 - Norfolk Multimodal Improvements\CAAD\Plan Sheets\DEMO-116057175.dwg  
This document, together with the concepts and designs presented herein, as an instrument of service, is intended only for the specific purpose and client for which it was prepared. Reuse of and improper reliance on this document without written authorization and adaptation by Kimley-Horn and Associates, Inc. shall be without liability to Kimley-Horn and Associates, Inc.



CITYWIDE PEDESTRIAN SAFETY IMPROVEMENTS PREPARED FOR CITY OF NORFOLK	DEMOLITION AND E&S PLAN JOHNSTONS TO LONGDALE STA. 110+50 TO STA. 122+50	COMMONWEALTH OF VIRGINIA ANGELA F. GALLAN Lic. No. 057183 08/11/2023 PROFESSIONAL ENGINEER	KHA PROJECT 116057175 DATE 08/14/2023 SCALE AS SHOWN DESIGNED BY MAM DRAWN BY MAM CHECKED BY AFC	Kimley»Horn © 2023 KIMLEY-HORN AND ASSOCIATES, INC. 4525 MAIN STREET, SUITE 1000, VIRGINIA BEACH, VA 23462 PHONE: 757-213-8600 FAX: 757-213-8601 WWW.KIMLEY-HORN.COM	REVISIONS	No.	By
						No.	By
						No.	By



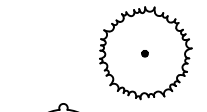

<u>DECIDUOUS TREES</u>	<u>QTY</u>	<u>BOTANICAL NAME</u>	<u>COMMON NAME</u>	<u>CONT</u>	<u>HEIGHT</u>
	11	Acer rubrum 'Autumn Blaze'	Autumn Blaze Red Maple	B & B	2" CAL. MIN.
	4	Platanus x acerifolia 'Bloodgood'	Bloodgood London Plane Tree	B & B	2" CAL. MIN.
<u>ORNAMENTAL TREES</u>	<u>QTY</u>	<u>BOTANICAL NAME</u>	<u>COMMON NAME</u>	<u>CONT</u>	<u>HEIGHT</u>
	7	Cercis canadensis 'Forest Pansy' TM	Forest Pansy Redbud	B & B	10' HT. MIN.
	6	Cornus x rutgersensis 'Stellar Pink'	Pink Flowering Stellar Dogwood	B & B	10' HT. MIN.
	9	Prunus x yedoensis	Yoshino Cherry	B & B	10' HT. MIN.
<u>EVERGREEN TREES</u>	<u>QTY</u>	<u>BOTANICAL NAME</u>	<u>COMMON NAME</u>	<u>CONT</u>	<u>HEIGHT</u>
	3	Ilex x 'Nellie R Stevens'	Nellie Stevens Holly	B & B	6' HT MIN.
	2	Magnolia grandiflora 'Little Gem'	Dwarf Southern Magnolia	B & B	6' HT MIN.

1. SEED ALL AREAS WITHIN PROPERTY LIMITS THAT ARE NOT COVERED WITH MULCHED PLANT BEDS, STONE MULCH, BUILDINGS, HARDCAPE, PAVEMENT, OR OTHERWISE NOTED.
2. SEED WITH PERMANENT LAWN GRASS ALL AREAS WITHIN THE RIGHT OF WAY WHICH ARE NOT OTHERWISE COVERED WITH PLANTING BEDS, PAVEMENT, BUILDINGS, OR HARDCAPE, PER THE SEEDING SPECIFICATIONS ON SHEET CP-501.
3. EXISTING TREES AND SHRUBS INDICATED TO REMAIN SHALL BE PROTECTED FROM CONSTRUCTION ACTIVITIES BY INSTALLING TREE PROTECTIVE FENCING PER THE PROJECT PLANS AND SPECIFICATIONS.
4. SEE SHEET 2F FOR PLANTING NOTES AND DETAILS.
5. SEE SHEET 2F FOR MASTER PLANT SCHEDULE.



Plotted By: Meyer, Morgan Sheet Set: CITYWIDE PEDESTRIAN SAFETY IMPROVEMENTS Layout: E&S DEMOLITION AND E&S PLAN August 14, 2023 09:30:59am K:\VAB-TPT\116057175 - Norfolk Multimodal Improvements\CAAD\Plan Sheets\DEMO-116057175.dwg  
This document, together with the concepts and designs presented herein, as an instrument of service, is intended only for the specific purpose and client for which it was prepared. Reuse of and improper reliance on this document without written authorization and adaptation by Kimley-Horn and Associates, Inc. shall be without liability to Kimley-Horn and Associates, Inc.

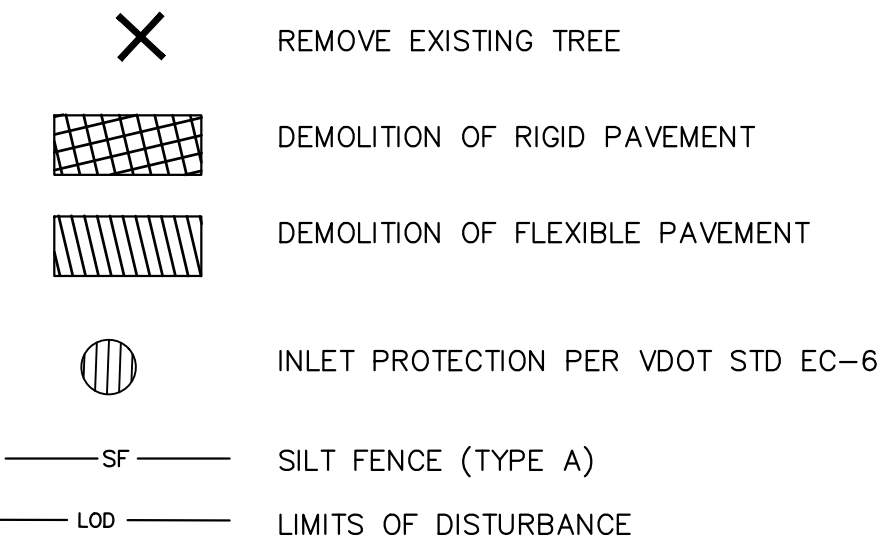
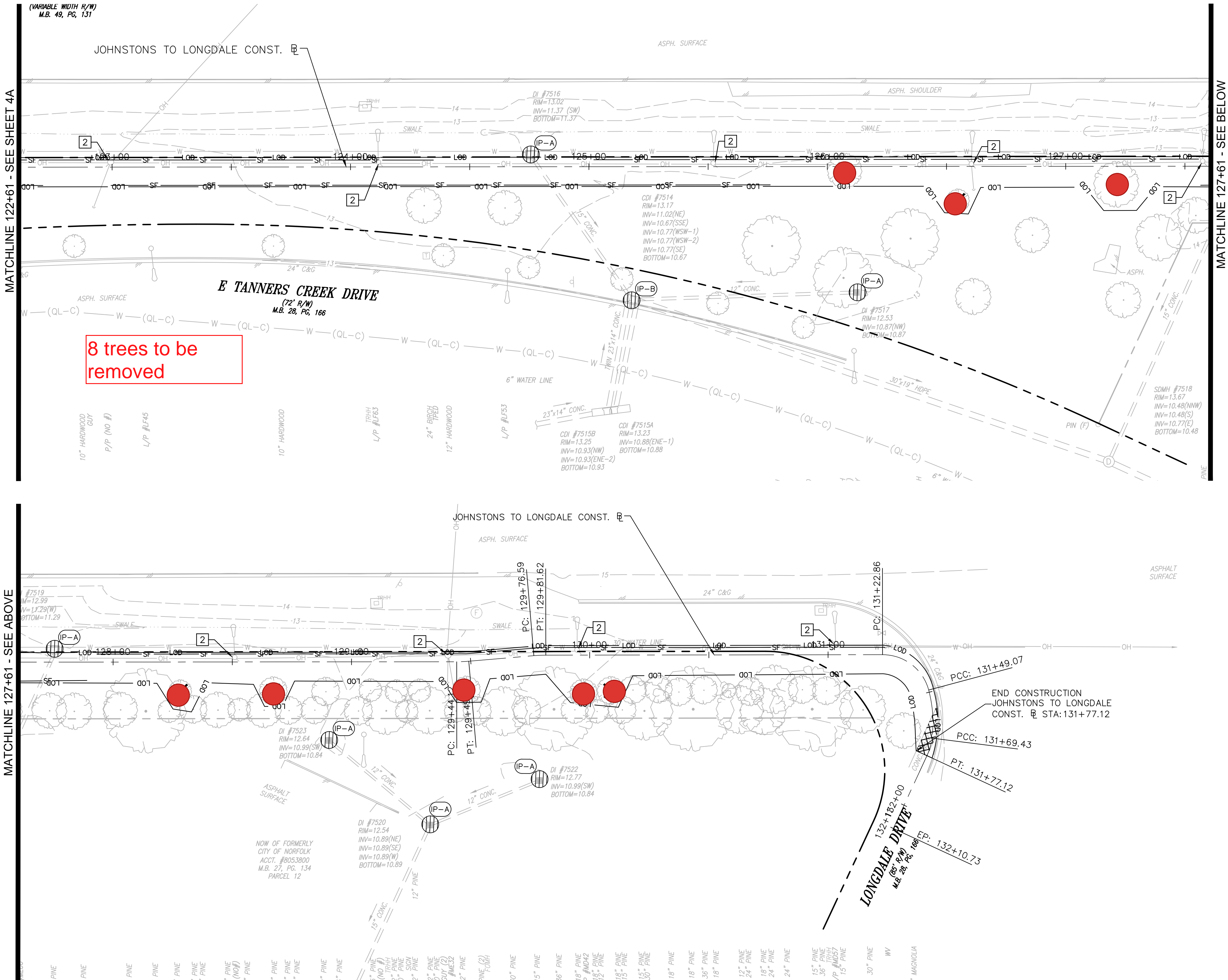
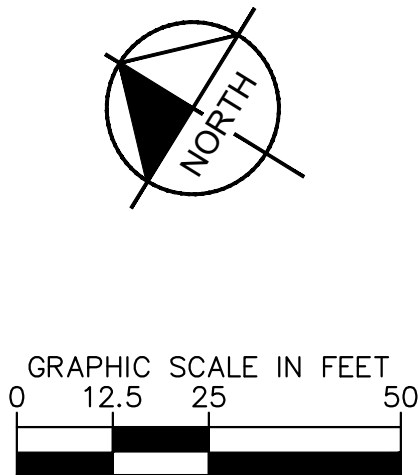

LEGEND

- CONTRACTOR TO SALVAGE EXISTING SIGN PANEL AND DEMOLISH EXISTING SIGN POST AND FOUNDATION
- DO NOT DISTURB EXISTING UTILITY
- ADJUST UTILITY TO GRADE
- SAWCUT EXISTING PAVEMENT
- DEMOLISH EXISTING CURB
- ERADICATE EXISTING PAVEMENT MARKINGS
- CONTRACTOR TO REMOVE EXISTING PUSH BUTTON AND SIGN
- CONTRACTOR TO REMOVE EXISTING SP-9 PEDESTRIAN SIGNAL HEAD AND PUSH BUTTON

NOTES:

- CONTRACTOR TO COORDINATE WITH DOMINION ENERGY FOR TREE REMOVAL IN CLOSE PROXIMITY TO OVERHEAD UTILITIES.
- THE CONTRACTOR SHALL APPLY ECS-1B BIODEGRADABLE MATTING OR AND APPROVED OTHER IN ACCORDANCE WITH VDOT STD. EC-3 TO ALL DISTURBED AREA WITHIN THE RIGHT OF WAY FOR FINAL STABILIZATION. THE COST OF THE MATTING SHALL BE INCIDENTAL TO THE SQUARE ACRE COST OF TOPSOIL CLASS A 2"
- THE CITY OF NORFOLK DOES NOT ALLOW GRAVEL/WIRE MESH INLET PROTECTION WITHIN THE CITY RIGHT OF WAY

CITYWIDE PEDESTRIAN SAFETY IMPROVEMENTS  
PREPARED FOR  
CITY OF NORFOLK

VIRGINIA

DEMOLITION AND E&S PLAN  
JOHNSTONS TO LONGDALE  
STA. 122+50 TO STA. 132+00

KHA PROJECT	116057175
DATE	08/14/2023
SCALE	AS SHOWN
DESIGNED BY	MAM
DRAWN BY	MAM
CHECKED BY	AFC

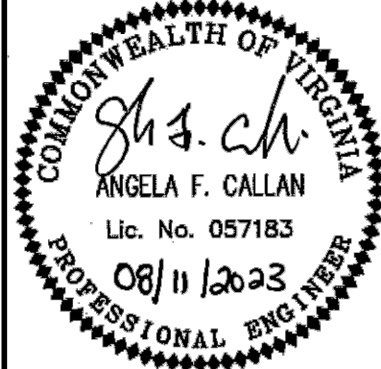

**Kimley»Horn**

© 2023 KIMLEY-HORN AND ASSOCIATES, INC.  
4525 MAIN STREET, SUITE 1000, VIRGINIA BEACH, VA 23462  
PHONE: 757-213-8600 FAX: 757-213-8601  
WWW.KIMLEY-HORN.COM

No.	REVISIONS	DATE	BY



Plotted By: Meyer, Morgan - Sheet Set: CITYWIDE PEDESTRIAN SAFETY IMPROVEMENTS - Layout: 5D LANDSCAPE PLAN - August 14, 2023 09:32:23am - K:\VAB-116057175 - Norfolk Multimodal Improvements\CADD\Plan Sheets\LANDSCAPE - 116057175.dwg  
This document, together with the concepts and designs presented herein, as an instrument of service, is intended only for the specific purpose and client for which it was prepared. Reuse of and improper reliance on this document without written authorization and adaptation by Kimley-Horn and Associates, Inc. shall be without liability to Kimley-Horn and Associates, Inc.

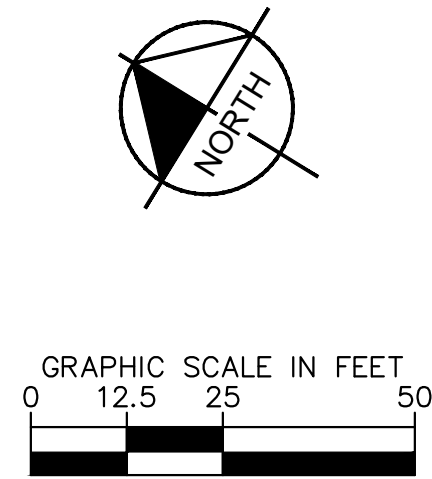

TOTAL  
76 TREES TO BE REMOVED  
76 TREES TO BE PLANTED



PLANT SCHEDULE - SHEET 5D

DECIDUOUS TREES	QTY	BOTANICAL NAME	COMMON NAME	CONT	HEIGHT
	4	Acer rubrum 'Autumn Blaze'	Autumn Blaze Red Maple	B & B	2" CAL. MIN.
	3	Betula nigra 'Dura-Heat'	River Birch Multi-Trunk	B & B	2" CAL. MIN.
ORNAMENTAL TREES	QTY	BOTANICAL NAME	COMMON NAME	CONT	HEIGHT
	5	Cercis canadensis 'Forest Pansy' TM	Forest Pansy Redbud	B & B	10' HT. MIN.
	4	Cornus x rutgersensis 'Stellar Pink'	Pink Flowering Stellar Dogwood	B & B	10' HT. MIN.

GENERAL NOTES:

- SEED ALL AREAS WITHIN PROPERTY LIMITS THAT ARE NOT COVERED WITH MULCHED PLANT BEDS, STONE MULCH, BUILDINGS, HARDSCAPE, PAVEMENT, OR OTHERWISE NOTED.
- SEED WITH PERMANENT LAWN GRASS ALL AREAS WITHIN THE RIGHT OF WAY'S WHICH ARE NOT OTHERWISE COVERED WITH PLANTING BEDS, PAVEMENT, BUILDINGS, OR HARDSCAPE, PER THE SEEDING SPECIFICATIONS ON SHEET CP-501.
- EXISTING TREES AND SHRUBS INDICATED TO REMAIN SHALL BE PROTECTED FROM CONSTRUCTION ACTIVITIES BY INSTALLING TREE PROTECTIVE FENCING PER THE PROJECT PLANS AND SPECIFICATIONS.
- SEE SHEET 2F FOR PLANTING NOTES AND DETAILS.
- SEE SHEET 2F FOR MASTER PLANT SCHEDULE.

CITYWIDE PEDESTRIAN SAFETY IMPROVEMENTS PREPARED FOR CITY OF NORFOLK	VIRGINIA	LANDSCAPE PLAN JOHNSTONS TO LONGDALE STA. 122+50 TO STA. 132+00	KHA PROJECT 116057175 DATE 08/14/2023 SCALE AS SHOWN DESIGNED BY MAM DRAWN BY MAM CHECKED BY AFC		Kimley»Horn © 2023 KIMLEY-HORN AND ASSOCIATES, INC. 4525 MAIN STREET, SUITE 1000, VIRGINIA BEACH, VA 23462 PHONE: 757-213-8600 FAX: 757-213-8601 WWW.KIMLEY-HORN.COM	REVISIONS	BY
						No.	DATE